

NORMAN HYDE FOOTREST KIT TILO

1. Check all parts against list.
2. Assemble as diagrams, with grease at gear pedal pivot.
3. Adjust gear linkage rod length to affect pedal height.

BCS 541-154/A

DRIVE SIDE

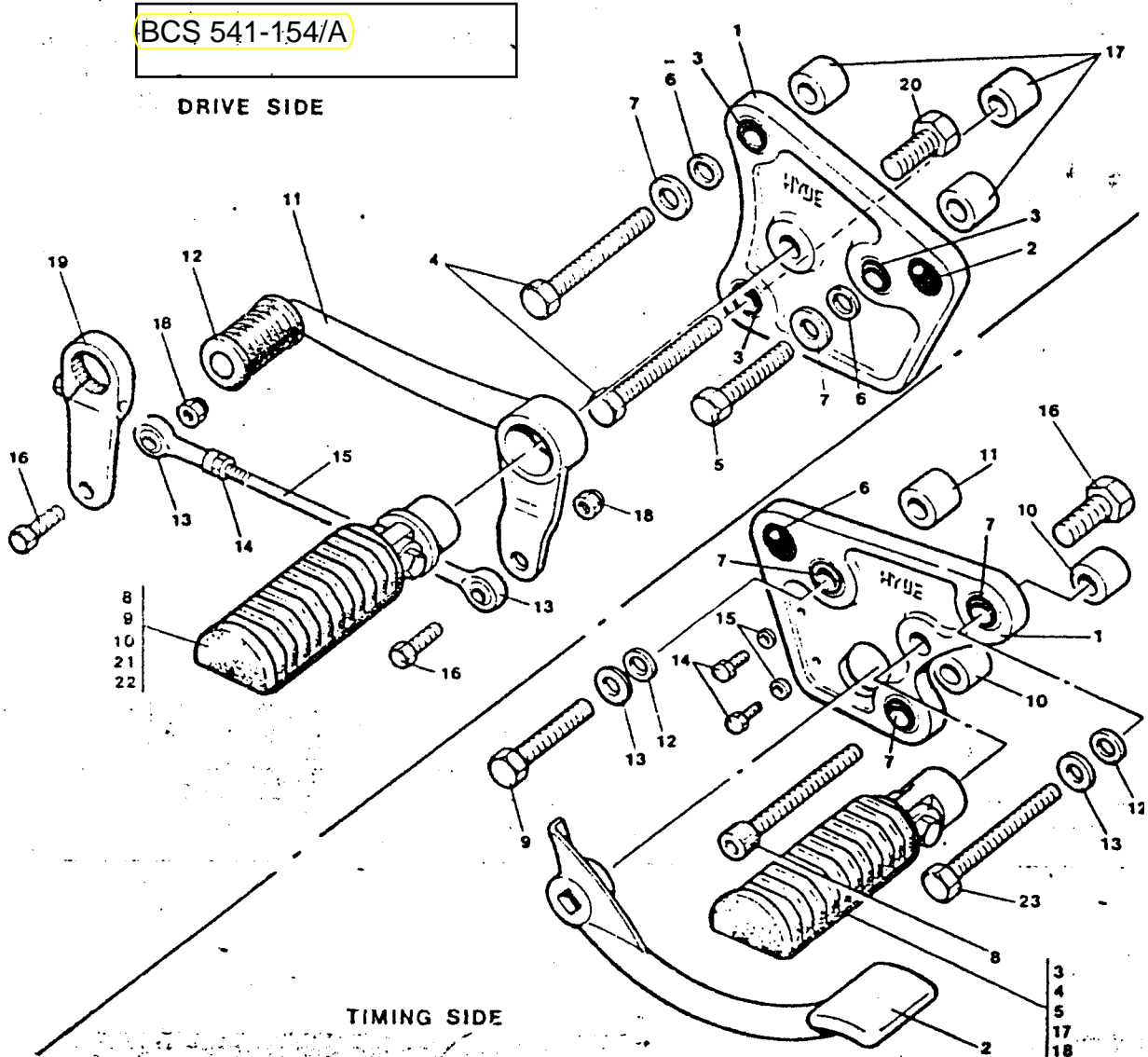

TIMING SIDE

TIMING SIDE

Pt.No.

- |                                       |       |      |
|---------------------------------------|-------|------|
| 1. Aluminium side plate               | 1 off | 1100 |
| 2. Brake pedal assembly               | 1 "   | 1101 |
| 3. Footrest boss                      | 1 "   | 1147 |
| 4. " blade                            | 1 "   | 1181 |
| 5. " rubber                           | 1 "   | 1107 |
| 6. Blind grommet                      | 1 "   | 1108 |
| 7. Rubber/metal bush 5/16" bore       | 3 "   | 1109 |
| 8. Allen screw 3"x5/16" UNF           | 1 "   | 1110 |
| 9. Bolt 5/16"x2"                      | 1 "   | 1117 |
| 10. Spacer 5/16"x21/64" I/Dx5/8" O/D2 | "     | 1111 |
| 11. " 9/16"x21/64" I/Dx5/8" O/D1      | "     | 1112 |
| 12. Washer 0.32"x17/32"x0.05"         | 2 "   | 1113 |
| 13. " 7/8"x21/64"x0.05"               | 2 "   | 1114 |
| 14. Screw 2BAx3/8"                    | 2 "   | 1115 |
| 15. Washer 2BA                        | 2 "   | 1116 |
| 16. Bolt 3/8" UNFx7/8"                | 1 "   | 1118 |
| 17. Pivot bolt 5/16"x1"               | 1 "   | 1119 |
| 18. " " - nut                         | 1 "   | 1120 |
| 23. Bolt 3"x5/16" UNF                 | 2 "   | 1149 |

DRIVE SIDE

- |                                      |       |      |
|--------------------------------------|-------|------|
| 1. Aluminium side plate              | 1 off | 1099 |
| 2. Grommet                           | 1 "   | 1108 |
| 3. Rubber/metal bush                 | 3 "   | 1109 |
| 4. Bolt 2 1/2"x5/16" UNF             | 2 "   | 1121 |
| 5. " 2"x5/16" UNF                    | 1 "   | 1117 |
| 6. Washer 0.32"x17/32"x0.05"         | 2 "   | 1113 |
| 7. " 7/8"x21/64"x0.05"               | 2 "   | 1114 |
| 8. Footrest boss                     | 1 "   | 1105 |
| 9. " blade                           | 1 "   | 1106 |
| 10. " rubber                         | 1 "   | 1107 |
| 11. Gear pedal assembly              | 1 "   | 1122 |
| 12. " " rubber                       | 1 "   | 1124 |
| 13. Rose joint                       | 2 "   | 1125 |
| 14. 1/4" nuts 1/4" UNF               | 2 "   | 1126 |
| 15. 1/4" rod 7" O/A                  | 1 "   | 1127 |
| 16. Bolt 1/4" UNFx3/8"               | 2 "   | 1128 |
| 17. Spacer 9/16"x21/64" I/Dx3/8" O/D | 3 "   | 1112 |
| 18. Locking nuts 1/4" UNF            | 2 "   | 1130 |
| 19. Operating lever                  | 1 "   | 1131 |
| 20. 3/8" UNFx7/8" bolt               | 1 "   | 1118 |
| 21. Bolt 5/16"x1"                    | 1 "   | 1119 |
| 22. Nut " locking                    | 1 "   | 1120 |